

SLIMGLASS 2-350

MARINE GRADE ENGINE ROOM LIGHT

Designed for Marine Electrical Instability

IP67 Front Rated | 80V Extended Tolerance

STEIN TECHNOLOGY



Efficient heat dissipation design minimizes overheating and reduces fire risk.

TECHNICAL SPECS

ELECTRICAL DATA

System Power	24 Watt
Nominal Operating Voltage	20-30V DC (220 VAC optional)
Extended Voltage Tolerance	Up to 80V DC (temporary operation)
Energy Efficiency	Up to 98%
Dimming	PWM dimmable (compatible with 1-10V and DALI systems via suitable driver)

OPTICAL PERFORMANCE

Luminous Flux	3,600 lm
Luminous Efficacy	150 lm/W
Color Rendering Index (CRI)	≥90
Beam Angle	140°
Rated Lifetime	L70 lifetime >100,000h
Color Consistency	3-Step MacAdam Ellipse

PROTECTION & SAFETY

Reverse Polarity Protection	Full electronic protection
Ingress Protection Architecture	IP67 front exposure
Operating Ambient Temperature	-40°C to +60°C

DIMENSIONS

These dimensions can be optionally changed

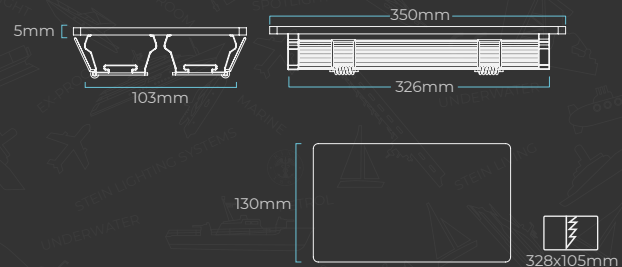

BEAM ANGLE

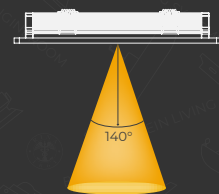

MOUNTING

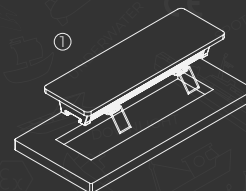

- Drill the ceiling panel according to the specified dimensions.
- Fold the product's spring clips backward as shown, then insert the product into place.

FINISHES



Semi-translucent plexiglass

LIGHT COLORS



6500K 4000K 3000K RED BLUE GREEN

