

FOGGY POWER

MARINE GRADE DOWNLIGHT

Designed for Marine Electrical Instability

IP65 Front Rated | 80V Extended Tolerance | Zero EMI | Integrated Aluminum Driver

Thermal & High Voltage Protection | Custom Sizes & Finishes Available

STEIN TECHNOLOGY



Automatic Thermal Regulation
With Adaptive Power Control



Efficient heat dissipation design
minimizes overheating and
reduces fire risk.



EMI-Free Operation

TECHNICAL SPECS

ELECTRICAL DATA

| | |
|----------------------------|---|
| System Power | 1.5 Watt |
| Nominal Operating Voltage | 20-30V DC |
| Extended Voltage Tolerance | Up to 80V DC (temporary operation) |
| Energy Efficiency | Up to 98% |
| Dimming | PWM dimmable (compatible with 1-10V and DALI systems via suitable driver) |

OPTICAL PERFORMANCE

| | |
|-----------------------------|------------------------|
| Luminous Flux | 180 lm |
| Luminous Efficacy | 120 lm/W |
| Color Rendering Index (CRI) | ≥90 |
| Beam Angle | 45° |
| Rated Lifetime | L70 lifetime >100,000h |
| Color Consistency | 3-Step MacAdam Ellipse |

PROTECTION & SAFETY

| | |
|---------------------------------|---|
| Reverse Polarity Protection | Full electronic protection |
| Surge Immunity | IEC transient protection compliant up to 200V (short-duration spikes) |
| Driver Construction | Fully integrated aluminum-housed driver (no external plastic box) |
| Linear Constant Current Driver | No Switching Frequency |
| Flicker | 0% Flicker (No PWM / No High Frequency Modulation) |
| Ingress Protection Architecture | IP65 front exposure / IP64 ceiling cavity protection |

THERMAL MANAGEMENT

| | |
|---|---|
| Operating Ambient Temperature | -40°C to +60°C |
| Max Case Temperature | 70°C |
| Adaptive Thermal Regulation | Continuous thermal monitoring with dynamic current adjustment |
| Confined-Space Thermal Stability | Stable operation in low-ventilation ceiling cavities. |
| Adaptive Overvoltage Thermal Regulation | Automatic current derating under extended voltage conditions |

DIMENSIONS

These dimensions can be optionally changed

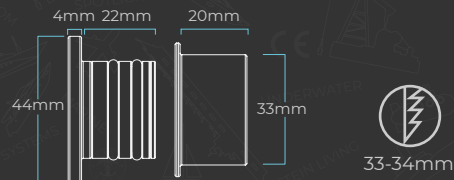

MOUNTING

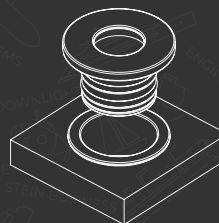

Place the mounting accessory of the product into the hole you have drilled

Attach the mounting accessory of the product firmly to the hole

Insert the product into the mounting accessory; it should fit snugly and securely

BEAM ANGLE

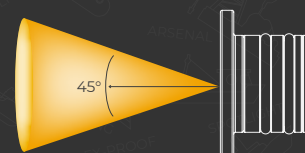

FINISHES

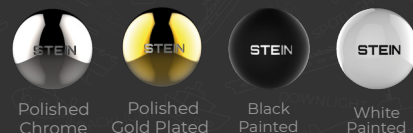

LIGHT COLORS

