

# Head X2-25 New High Tech Series

! Heat - High Voltage - Peak- Protected  
Does Not Produce Frequency Interference

Marine grade downlight



**STEIN**  
MARINE LIVING

Optional

Special Arrangements Can Be Made For Projects  
Including Different Sizes, Materials, Material Colors



## Product Specifications

Power Consumption	: 5 X 2 = 10 Watt
Standart Voltage Internal Driver	: 12 Or 24 VDC Protected 60 VDC
Optional Driverless	:
Light Source Led	: LED
Dimmable	: PWM, Voltage, Current
Luminous Flux	: 1.400 Lumens

## Dimensions

Temp Control	Does Not Cause fire	Voltage Limit

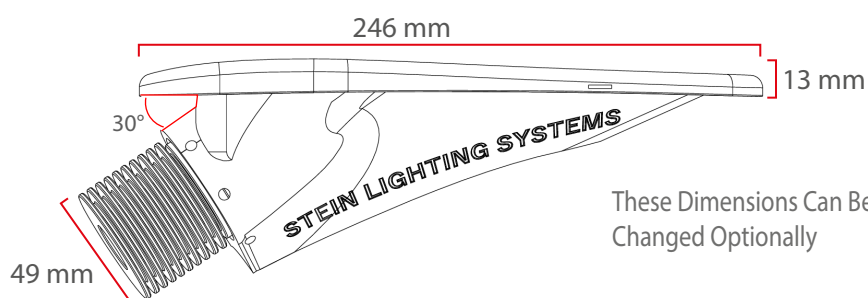

These Dimensions Can Be Changed Optionally

## Material Colors



And Other Ral Codes

## Standart Connection

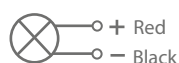

## Light Angle

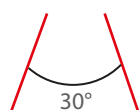

## Mounting

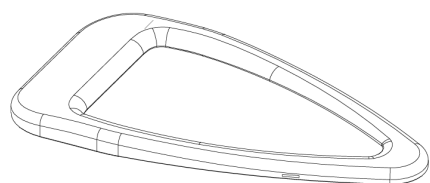

Remove the cap of the product, apply insulation material to the rear side of the product, and secure it with screws at the indicated locations as per the technical drawing.

The hole template will also be provided along with the product.

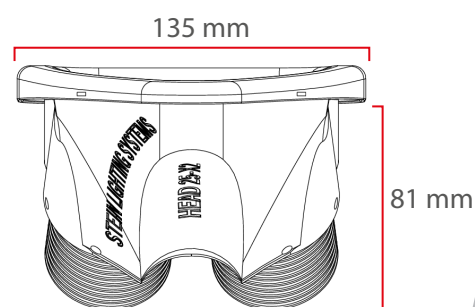

The Driver Is Protected In An Aluminum Housing

## Light Colors

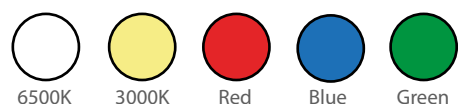

## Certifications

